

OASIS17-P19

Plot Surface: 733,33m²

GROUND FLOOR

Building Surface

Ground Floor	102.36m ²
Terrace	55.50m ²
Pool	31.50m ²

TOTAL BUILD GROUND FLOOR 189.36m²

Built Area sqm

Ground Floor	189.36m ²
First Floor	141.40m ²

TOTAL BUILT AREA 330.76m²

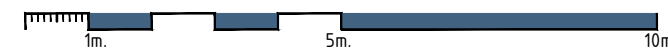
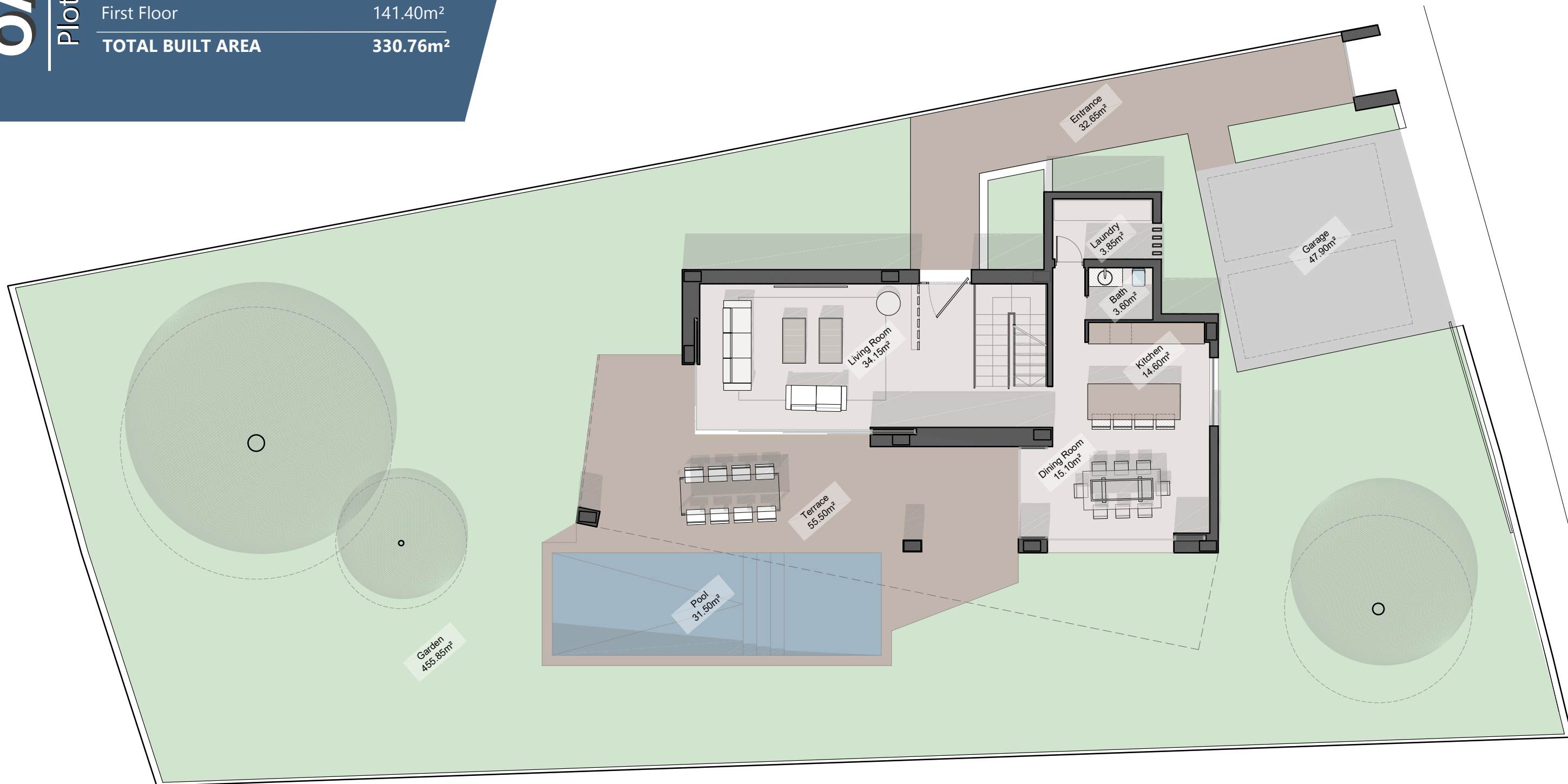
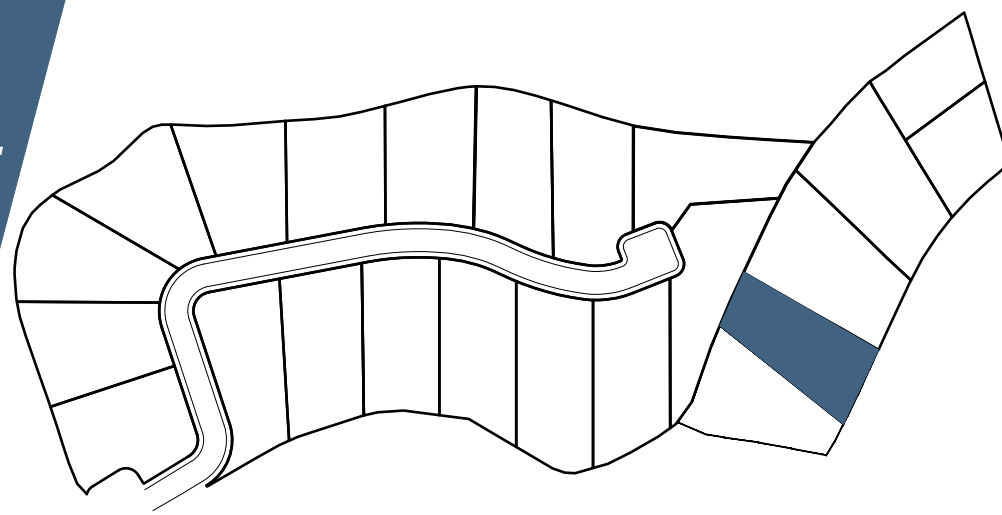

OASIS17-P19

Plot Surface: 733,33m²

FIRST FLOOR

Building Surface

First Floor 101.00m²
Terrace 40.40m²

TOTAL BUILD FIRST FLOOR 141.40m²

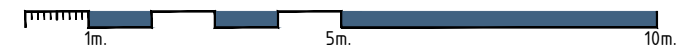
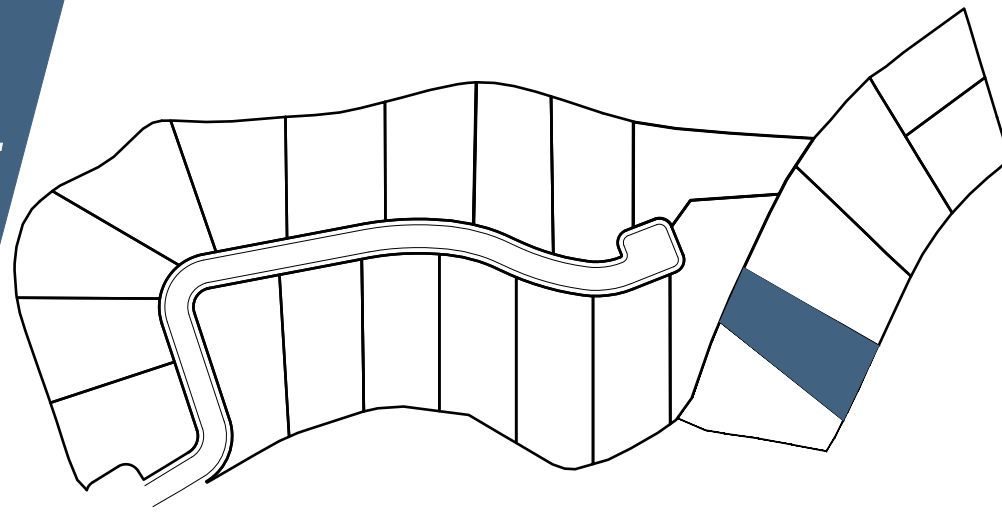

NOTA: Estos planos son orientativos, pudiendo sufrir modificaciones durante el desarrollo del proyecto, a juicio de la dirección técnica y de los organismos competentes. El mobiliario es figurativo no vinculante.

NOTE: These plans are for guidance only, and may change during the project, according to the technical management. Figurative furniture is not binding.

OASIS17-P19

Plot Surface: 733,33m²

OPTION SOLARIUM SOLARIUM

Building Surface

Solarium 96.80m²

TOTAL BUILD SOLARIUM 96.80m²

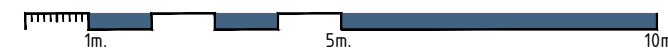
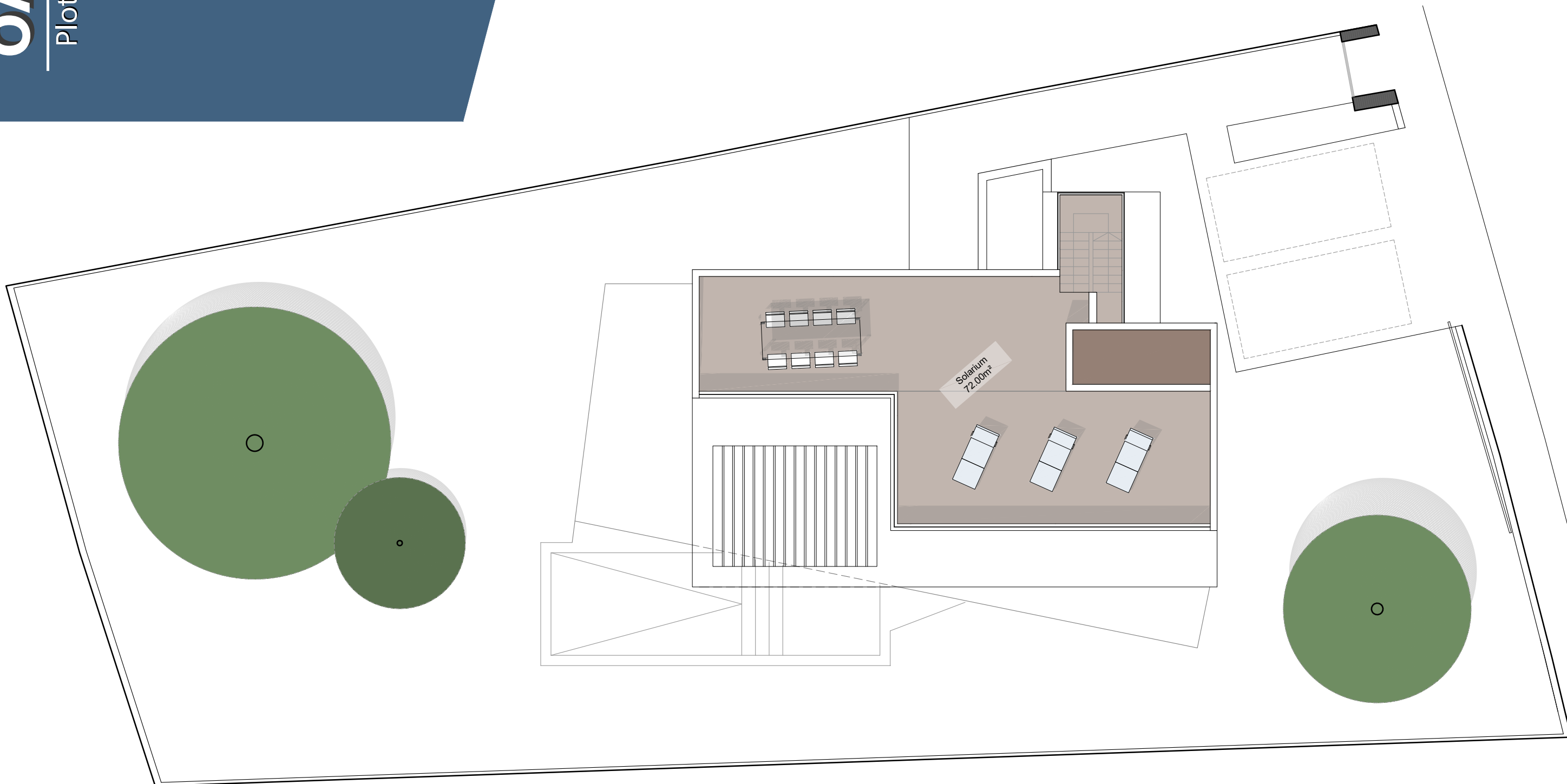
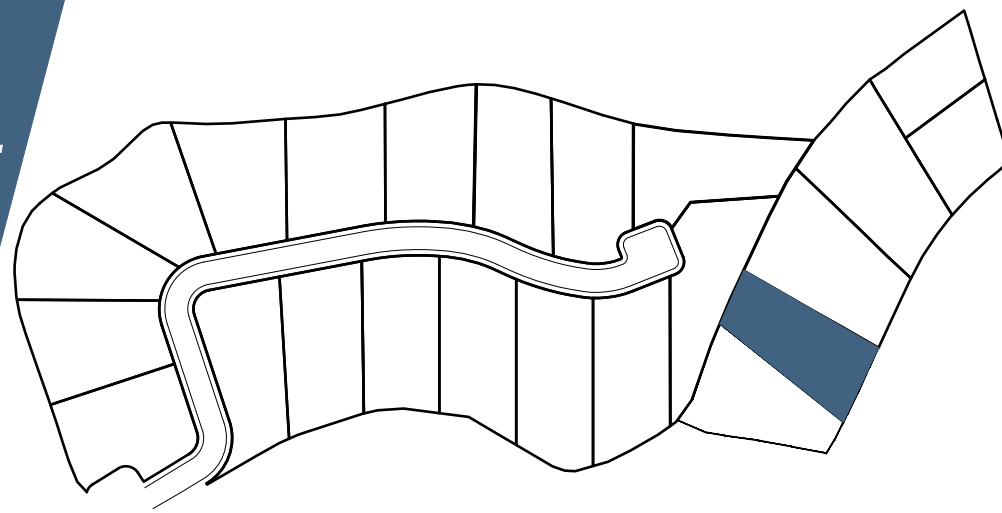

NOTA: Estos planos son orientativos, pudiendo sufrir modificaciones durante el desarrollo del proyecto, a juicio de la dirección técnica y de los organismos competentes. El mobiliario es figurativo no vinculante.

NOTE: These plans are for guidance only, and may change during the project, according to the technical management. Figurative furniture is not binding.

OASIS17-P19

Plot Surface: 733,33m²

BASEMENT 112.00m²

Building Surface

Basement 112.00m²

TOTAL BUILD BASEMENT 112.00m²

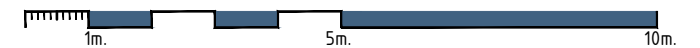
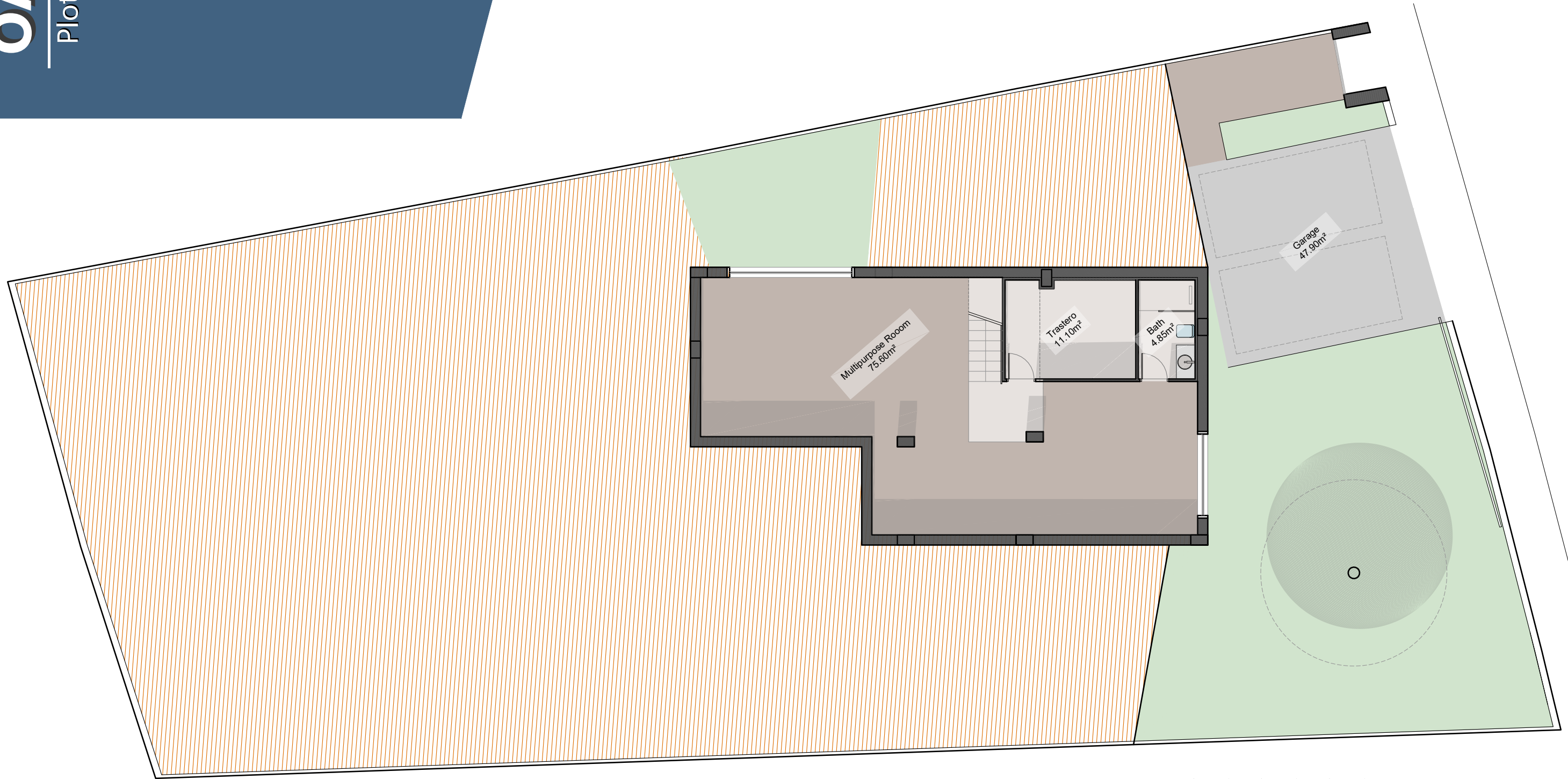
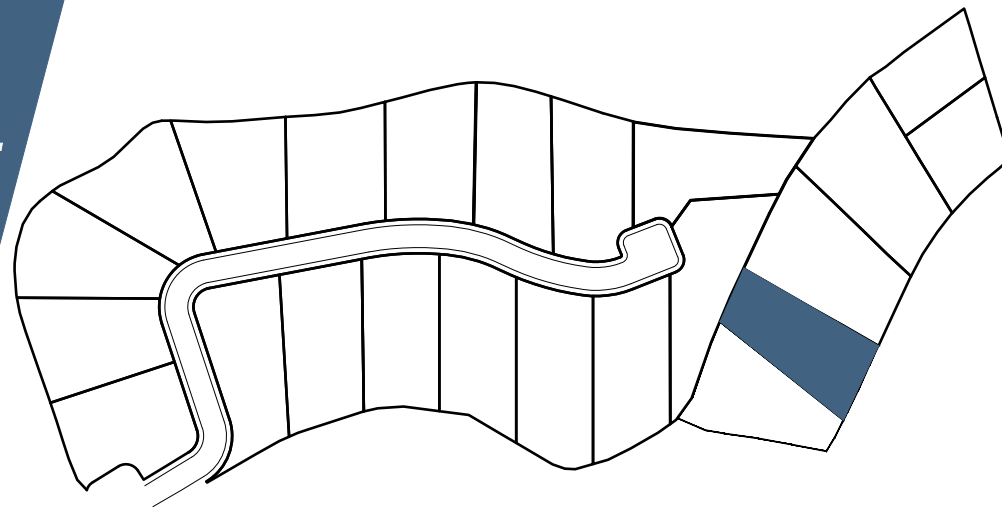

NOTA: Estos planos son orientativos, pudiendo sufrir modificaciones durante el desarrollo del proyecto, a juicio de la dirección técnica y de los organismos competentes. El mobiliario es figurativo no vinculante.

NOTE: These plans are for guidance only, and may change during the project, according to the technical management. Figurative furniture is not binding.